



SHORT EXPOSURES



**f:67 Camera Club, P.O. Box 105, Allyn, WA 98524,
Meeting regularly at the Olympic College campus
In Bremerton, Washington;
Member of the Photographic Society of America
and the Northwest Council of Camera Clubs.**

March and April, 2012

F:67 Camera Club Officers

President – Bob Paul, 7860 Amethyst Loop NW, Silverdale, WA 98383-5075, (360) 692-0165

Vice-president – Victoria Braden, 13110 Lakeridge Circle NW, Silverdale, WA 98383, (360) 394-5520.

Secretary (co-secretaries) – Jeanette Kelso, 1971 Cook Lane, Bremerton, WA 98383, (360) 479-0292

Treasurer – Lionel Harris, 270 NE panther Lake Road, Bremerton, WA 98312-9348, (360) 275-5540.

Slide Director – Jack Templeton, 3484 SE Azalea Street, Port Orchard, WA 98366, (360) 895-0848.

Digital Projection Co-Directors – Robert and Virginia Richter, 6266 NE Barrett Dr, Poulsbo, WA 98310.

Print Directors – Steve Fisher (Steve) 1220 8th Street, Bremerton, WA 98337-1255, (360) 377-9506.

PSA Director (also known as “PSA Club Representative”) – Steve Fisher, 1220 8th Street, Bremerton, WA 98337-1255, (360) 377-9506.

Invitation and Traveling Show Director – Adam Escalona, 337 North Cambrian Avenue, Bremerton, WA 98312-4006, (360) 377-6843.

Education/Program Director – Jerry Joaquin, Box 105, Allyn, WA 98524, 191 Lakeshore Dr., Allyn, WA, (360)275-3019.

THE DIRECTOR POSITIONS FOR 2011: Digital Projection – Robert and Virginia Richter; Slides – Jack Templeton; Prints – Steve Fisher; Invitation and Traveling Show – Adam Escalona; Education/Program Director – Jerry Joaquin.

The Club Calendar

Monday, Mar 5, 2012 * 6:45P. M. Projected image evaluation night.
Categories are General and Creative

Monday, Mar 19, 2012 6:45P. M. Print Night.
Categories are General and Still Life.

Monday, Mar 26, 2012 7:00 PM Business meeting; Home of Christina Krueger

Monday, Apr 2, 2012 * 6:45PM Projected image evaluation night.
Categories are General and Photojournalism

Monday, Apr 16, 2012 6:45PM. Print Night.
Categories are General and Creative

Monday, Apr 23, 2012 7:00 PM Business meeting: Jerry Joaquin
Timberland Library, 23081 NE State Route 3, Belfair, WA

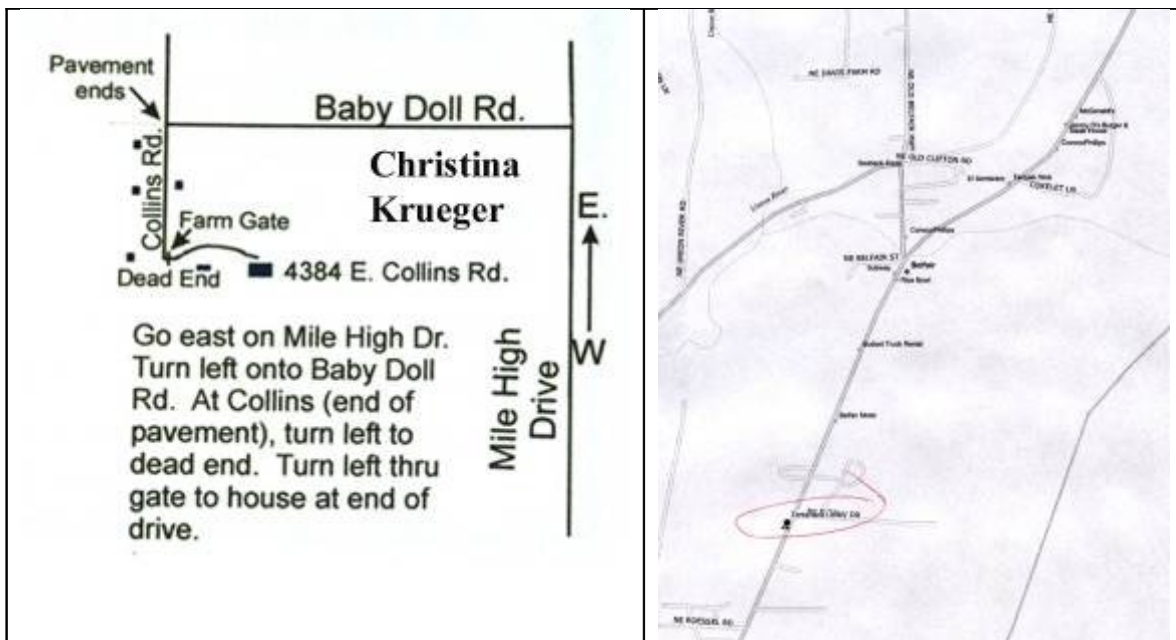

IT'S TIME FOR THE ANNUAL SALON !!!

**SUNDAY, MARCH 18, 2011, STARTING 4:30PM, MASONIC HALL,
SIDNEY AVENUE, PORT ORCHARD.
PRINT SHOW OPENS AT 4:00PM, COME EARLY.**

**POT LUCK; SILENT AUCTION (BRING SOMETHING TO AUCTION
OFF, AND MONEY TO BUY GOODIES AUCTIONED OFF.
LET CHRISTINA KRUEGER KNOW IF YOU ARE COMING TO THE
SALON....RSVP EARLY, AS THERE IS MUCH PLANNING TO BE
DONE!**

**LET THE PERSON IN CHARGE OF THE AUCTION (TO BE
DETERMINED) KNOW WHAT YOU ARE BRINGING TO AUCTION
OFF. LOTS OF FUN AND GOOD DEALS.**

**IT IS THE SOCIAL TIME AND FRIENDSHIPS THAT MATTER THE
MOST. PLEASE JOIN US!**

The annual show is meant to be a social event (families and significant others invited), an opportunity to provide awards and encouragement for photographic achievement, and a chance to enjoy the photography of all participating club members. See you there!

PRINTS.

Categories are GENERAL, NATURE, PEOPLE/PORTRAIT, ANIMALS, PHOTOJOURNALISM, PHOTO TRAVEL, CREATIVE, STILL LIFE and PLANTS. The club's criteria for these categories apply to the annual salon categories.

Images are exhibited by annual show category, without regard to a member's A or B classification. A total of **8 prints** have been submitted, with **no more than 3 prints in any category**, must have been shown or in the past year's print nights, and not entered in a previous salon. Prints shown on print nights in previous years, but not entered in previous annual salons, are eligible for the current annual salon as part of the maximum of entries allowable, if they are displayed at the end of the last year, shown on the light box separately from that print night's prints. Minor changes from print nights may be made; e.g. enlargement, exposure, burning/dodging, minor cropping. Size minimum is 8"x10 and maximum is 16"x20", and total presentation maximum is 16"x20", and matt or support backing of cardboard not exceeding 1/4" thick is required. No frames will be accepted. Entry slips must accompany prints. On reverse, mark image title on upper left hand corner, and maker name, category and exhibition number (entry slip number) on upper right hand corner. In the middle, mark "TOP" and place an arrow pointing to the top of the print. There is to be no writing on the face of the print.

The prints will be judged by judges selected from another photography club. Awards include ribbons for 1st, 2nd, 3rd places and honorable mentions. Special awards include the following:

1. **Achievement Award.** Class B (club member classification B) member receiving highest total points accumulated during the monthly exhibitions.
2. **Serry Landscape/Seascape Print Perpetual Trophy.** For the best monochrome or color landscape or seascape chosen by the judges.
3. **Richard Huhn Memorial Portrait Print Perpetual Trophy.** For the maker whose print exemplifies the best Portrait photography in any of its presentations.
4. **Color Award.** For the top color print in the salon, without regard to category.
5. **Best of Show.** For the top print from all the salon entries.
6. **Photojournalism Award.** For the print that shows action or human interest in a newsworthy story.
7. **Black and White Award.** For the top black and white print in the salon, without regard to category.
8. **Photo Travel.** For the print which best captures the feeling of time and place and portrays a land, a people or culture in its natural state.
9. **Wildlife Award.** For the best print which is restricted to Nature images which are Authentic Wildlife, defined as one or more organisms living free and unrestrained in their natural and self-adopted habitat. Excluded are cultivated flowers or plants, domestic or stuffed animals, images containing humans or the human element, or animals or plants taken in zoos, game farms, conservatories, or other controlled environments. **Landscapes, photographs of zoo animals, or Game Farm animals or any living subject taken under controlled conditions are NOT eligible for Wildlife competitions.** Each entrant verifies that the image qualifies as authentic wildlife by placing a “W” after the annual show category designation on the entry slip.

PROJECTED IMAGES (SLIDES AND DIGITAL IMAGES).

Categories are GENERAL, NATURE, PEOPLE/PORTRAIT, STILL LIFE, PHOTOJOURNALISM, PHOTO TRAVEL, CREATIVE, ANIMAL, and PLANTS. The club’s criteria for these categories apply to the annual salon categories.

Images are submitted by annual show category, without regard to a member’s A or B classification. A total of **20 slides** and **15 digital images** Have been submitted, with **no more than 4 slides and no more than 5 digital images in any one category**, which must have been shown or in the past year’s projection nights, and not entered in a previous salon. Images shown on projection nights in previous years, but not entered in previous annual salons, are eligible for the current annual salon as part of the maximum number of entries allowable, if they are displayed (projected separately from that projection night’s projected images) during the last two monthly exhibitions of the year. Slides may be in glass, cardboard or plastic mounts, must have a thumb spot in the lower left hand corner as the slide is viewed, hand held, and marked in accordance with rules for monthly exhibition. All digital files must be JPEG, 350 kilobytes maximum file size, 768 pixels maximum vertical dimension, and 1024 pixels maximum horizontal dimension. The file name can be the name used for the monthly exhibitions, but at least must identify the image title, maker’s name, annual show category, entry slip number, and projection night date.

The projected images will be judged by judges selected from another photography club. Awards include ribbons for 1st, 2nd, 3rd places and honorable mentions. Special awards include the following:

1. **Slide and Digital Image of the Year.** For the top slide and digital images from among all the 1st place winners in the categories. * for slides only, the award is called the **Marge Biedel Award**.
2. **Slide and Digital Photographer of the Year.** For the photographer with the highest total points for his or her 5 slide or digital images with the highest points awarded. Ties between makers will be broken by the highest point total on the 6th image, and then the 7th image or later image, until the tie is broken. * for slides only, the award is called the **Dr C.W. Biedel Award**.
3. **Class B Achievement Award.** For the club member who has accumulated the highest projection night point total during the last calendar year in slides and digital images.
4. **Class B Salon Photographer of the Year.** For the club member with the highest point total from the top 8 slide or digital entries in the annual salon.
5. **Photojournalism Award.** For the best slide and digital image that shows action or human interest in a newsworthy story.
6. **Wildlife Award.** For the best slide and digital image which is restricted to Nature images which are Authentic Wildlife, defined as one or more organisms living free and unrestrained in their natural and self-adopted habitat. Excluded are cultivated flowers or plants, domestic or stuffed animals, images containing humans or the human element, or animals or plants taken in zoos, game farms, conservatories, or other controlled environments. **Landscapes, photographs of zoo animals, or Game Farm animals or any living subject taken under controlled conditions are NOT eligible for Wildlife competitions.** Each entrant verifies that the image qualifies as authentic wildlife by placing a “W” after the annual show category designation on the entry slip. * called the **Edman Authentic Wildlife Award** for slides only.
7. **Landscape/Seascape Award.** For the best digital image which depicts a landscape or seascape, including both pastoral and urban landscapes. * called the **Stotts Landscape/Seascape Memorial Award** for slides only.
8. **Still Life Award.** For the top digital image with “Table Top”, “Flower Arrangement”, or “Small Still Life” subject matter, where the lighting is either natural or artificial, but if natural some measures of control shall have been exercised. * called the **Marion Newman Memorial Award** for slides only.
9. **Photo Travel Award.** For the best digital image which captures the feeling of time and place and portrays a land, a people or a culture in its natural state, without geographic limitation, and the judges can select from a digital image which fits the definition and is entered in any category in the annual show. * called the **Pollock Photo Travel Memorial Award** for slides only.
10. **Creative Award.** For the best creative slide and digital image, including abstractions, patterns, and design or a photograph that depicts subjects in a departure from realism through the use of various techniques, controls and processes. * called the **Bennett Creative Slide Award** for slides only.

A LOOK AHEAD

Month	Type	Category
Mar 5	Digital	Creative
Mar 19	Prints	Still Life*
Apr 2	Digital	Photojournalism
Apr 16	Prints	Creative
May 7	Digital	Plants
May 21	Prints	People/Portrait
Jun 4	Program	TBD
Jun 18	Prints	Animal
Jul 2	Digital	Showing Motion
Jul 16	Prints	Photojournalism
Aug 6	Program	TBD
Aug 20	Prints	Car Parts
Sep 3	Digital	Photo Travel
Sep 17	Prints	Nature
Oct 1	Digital	Animal **
Oct 15	Program	TBD
Nov 5	Digital	Fall Colors **
Nov 19	Prints	Photo Travel
Dec 3	Digital	Still-Life

Special Categories

- * This is the rescheduled of the canceled Jan Print Night
- ** This is a change from the original schedule. This change was made to allow time to take fall colors in Sept.

Monday Night Results for Projections

Projected Image Evaluation, Jan 2, 2012. GENERAL, NATURE

Digital Images			Slides		
Class B General			Class B General		
Reflections	Brian Phinney	1 st	<i>No Entries</i>		
Ocean View 17 Mile Drive	Robert Richter	2 nd			
Phone home	Brian Phinney	3 rd			
Class B Category			Class B Category		
The Wind 'Neath My Wings	Brian Phinney	1 st	<i>No Entries</i>		
Bean Creek Shooting Stars	Brian Phinney	2 nd			
Sword Frond	Virginia Richter	3 rd			
Class A General			Class A General		
Colorado Church	Lionel Harris	1 st	clear crystals	Larry Anderson	1 st
Fall Color 3 2011	Jim Haney	1 st	Ancient story	Larry Anderson	2 nd
Looking Down the Tracks	Bob Paul	1 st	Fog bank	Robert Finley	2 nd
Class A Category			Class A Category		
Doe & twin fawns - Philmont	Steve Fisher	1 st	Cuttle - Ready to Propel	Steve Fisher	1 st
Killdeer 4-1-11	Jim Haney	1 st	Sun Star attacking p.s King Crab	Steve Fisher	2 nd
Aminita Muscaria 2 10-16-11	Jim Haney	3 rd	Zion layers	Larry Anderson	2 nd
Elk Creek in Colorado	Lionel Harris	3 rd			
Pink Flamingo	Adam Escalona	3 rd			
<i>Total A 23</i>	Total A 9		Total A 9	Total A	
<i>Total B 11</i>	Total B 3		Total B 0	Total B 0	
<i>Tot. A+B 34</i>	Tot. A+B 12		Tot. A+B 9	Tot. A+B 3	

Print Evaluation, Feb 20 , 2012. GENERAL, Plants

Class B General		
The Thinker	Jeanette Kelso	1 st
Cloud in Mountain Valley	Pamela Bell	2 nd
Plowed Field with Snow	Pamela Bell	3 rd (Tie)
Shiny Pegasus	Bill Begert	3 rd (Tie) (Com Award)
Class B Category		
Flower Pot	Jeanette Kelso	1 st
Class B Black and White General		
No Entrants		
Class B Black and White Category		
No Entrants		
Class A General		
Sunset Lights Bay	John Davis	1 st (Com Award)
Laundry in Rome	Mary Westerback	2 nd
Open Sea Shell	Lionel Harris	3 rd
Class A Category		
Silver Sword at 10,033 ft.	Lionel Harris	1 st
Unusual Plant 5-10	Jim Haney	2 nd
Bird of Paradise	John Davis	3 rd
Class A Black and White, General		
Silhouette of Woman	John Davis	1 st (Com Award)
Gothic Door	Bob Paul	2 nd
Class A Black and White, Category		
Hot Tamale Droplets	John Davis	1 st (Tie)
Dandelion Puff 5-10	Jim Haney	1 st (Tie)
Total A: 31	Total A: 9	
Total B: 7	Total B: 3	
Total A+B: 38	Total A+B: 12	

Projected Image Evaluation, Feb 6, 2012. GENERAL, PEOPLE/PORTRAIT

Digital Images			Slides		
Class B General			Class B General		
Lena Creek Cascades	Brian Phinney	1 st	<i>No Entries</i>		
The Wave	Brian Phinney	1 st			
Artists Palette - Death Valley	Virginia Richter	2 nd			
Class B Category			Class B Category		
Paradise	Joe Krueger	1 st	<i>No Entries</i>		
Yessir, that's my baby	Brian Phinney	2 nd			
02 Listening to Coach (1)	Brian Phinney	3 rd			
Class A General			Class A General		
Sunset at Barinoche	Adam Escalona	1 st	Stump Reflections	Steve Fisher	1 st
Clouded Bells	Ray Lassila	2 nd	Show off	Robert Finley	2 nd
Antelope Canyon Collage	Lionel Harris	3 rd	First Snow Denali	Jack Templeton	2 nd
Class A Category			Class A Category		
Renaissance Old Guy	Lionel Harris	1 st	Tourists Feeding Chipmonks	Jack Templeton	1 st
Fallen Angel 5-10	Jim Haney	2 nd	The Blond	Jean Wright	2 nd
Marine with Mascot	Lionel Harris	2 nd			
<i>Total A 6</i>	<i>Total A 19</i>		<i>Total A 5</i>	<i>Total A 20</i>	
<i>Total B 4</i>	<i>Total B 10</i>		<i>Total B 0</i>	<i>Total B 0</i>	
<i>Tot. A+B 10</i>	<i>A+B 29</i>		<i>Tot. A+B 5</i>	<i>Tot. A+B 20</i>	

**GALLERY OF 1ST PLACE AND AWARDED
PROJECTION NIGHT IMAGES**

Jan 2, 2012



Reflections
By Brian Phinney



The Wind 'Neath My Wings
By Brian Phinney



Colorado Church
By Lionel Harris



Looking Down the Tracks
By Bob Paul



Fall Color 3 2011
By Jim Haney



clear crystals
By Larry Anderson



Cuttle - Ready to Propel
By Steve Fisher



Doe & twin fawns – Philmont
By Steve Fisher



Killdeer 4-1-11
By Jim Haney

**GALLERY OF 1ST PLACE AND AWARDED
PROJECTION NIGHT IMAGES
Feb 6, 2012**



Lena Creek Cascades
By Brian Phinney



The Wave
By Brian Phinney



Paradise
By Joe Krueger



Sunset at Barinoche
By Adam Escalona



Renaissance Old Guy
By Lionel Harris



Stump Reflections
By Steve Fisher



Tourists Feeding Chipmonks
Jack Templeton

**GALLERY OF 1ST PLACE AND AWARDED
PRINT NIGHT IMAGES
Feb 20, 2012**



Sunset Lights Bay
By John Davis



Silver Sword at 10,033 ft.
Lionel Harris



Silhouette of Woman
By John Davis



Hot Tamale Droplets
BY John Davis

PHOTO TIPS

(Reprinted from Short Exposures July/August 2008 by John Davis)

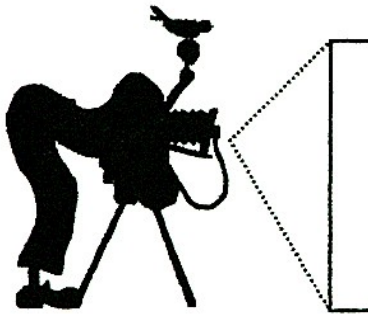

SOME TERMS AND THOUGHTS ABOUT BLACK AND WHITE OR MONOCHROME IMAGES

Black and White image making has retained its popularity. Amateurs and professionals continue to work with black and white with film (silverprinting) and digital photography. Camera, software, printer and ink improvements make for high quality digital black and white image making. Almost any color be easily selected for digital monochrome . Without color to “distract”, values (tones) and shape/form are more noticeable building blocks of a composition.

Tonal range is the range of tones or values from black to white available to the photographer. **High dynamic range** means very, very black to very, very bright white. **Contrast** describes the difference in values or tones. When contrast is high, more extreme darks are in very light surroundings, and very light lights are in very dark surroundings. High contrast increases **visibility**. Low contrast means less separation between the tones and less visibility. A photographer can create a **feel or mood** by selecting what tonal range the image will have, such as **low key** (black to light gray, for example) or **high key** (light gray to bright white for example). Within a narrower range of values or tones, contrast between the tones can be used to create the effect the photographer desires. Part of the fun of black and white photography is experimenting with the **relationships between values**. **Exposure** is important, in order to be sure that **shadows and highlights have the detail** the photographer wants. If the dynamic range is too great, photographers might more often choose to let the shadow areas go dark in order to preserve detail in the highlights.

Point, Line, Shape and Form. Absent color, points of black to white values form lines, and lines form **two-dimensional** shapes within the frame to create a graphic image. Form is used here to refer to **three-dimensional depth or volume**. The effective use of **light and shadow** helps create the shapes and the desired effect of these image elements. Instead of using color to attract and lead the eye, line and shape and form do. The intrigue of black and white images is how well these elements together with the desired tonal range and contrast can be used to communicate moods and feelings and tell a story, as well as (and some would say better than) images which use a palate of colors.

Try some black and white photography (or monochrome - one color for all tones like sepia) and make a couple of prints for the next night!

PHOTO CATEGORIES, Jan, Feb, and March 2012

GENERAL: Any subject is acceptable.

Still- Life (Print, 3/19/12)

An arrangement of stationary elements, non-living, where subject, composition, arrangement, and illumination have been significantly determined and controlled by the maker.

CREATIVE. (Print, 4/16/12)

Abstractions, patterns, and designs or a photograph that depicts subjects in a *departure-from-realism* through the use of various techniques, controls and processes.

PHOTOJOURNALISM (Projected, 4/2/12)

Pictures or sequences with informative content and emotional impact, including human interest, documentary and spot news. The journalistic value of the photograph shall be considered over the pictorial quality. In the interest of credibility, photographs which misrepresent the truth, such as manipulation to alter the subject matter, or situations which are set up for the purpose of photography, are unacceptable in Photojournalism competition. A human interest image is defined as an image depicting a person or persons in an interactive, emotional or unusual situation, excluding sports action.

PLANTS (Projected, 5/7/12)

Any living member of the plant kingdom: wild or domestic.

INTERCLUB COMPETITIONS

COMING UP, BRING YOUR IMAGES TO A MEETING:

The Photographic Society of America's (PSA) interclub image competitions provide club members with an opportunity to have their images judged by qualified judges and to measure their growth as photographers. The club will submit to several "interclubs" this coming season (beginning Sep-Oct each year and ending Apr-May). Those include:

One digital projection Group in Color (Color Projected Image Division or CPID – general category (Group "B")).

One digital projection Group in Nature (Nature Division or ND).

THE CLUB ESPECIALLY WANTS TO ENCOURAGE PARTICIPATION BY NEWER MEMBERS OF THE CLUB! THE SELECTION PROCESS IS USED TO SEND THE CLUB'S IMAGES IS ALSO AN EDUCATIONAL EXPERIENCE.

**INTERCLUB COMPETITION IMAGE REQUIREMENTS
ARE STATED IN RULES FOR EACH PSA DIVISION
WHERE F:67 ENTERS DIGITAL IMAGES**

PSA Division	File Type	Color Space	MAX File Size	Maximum horizontal pixel dimensions	Maximum vertical pixel dimensions
CPID	JPG	Not stated, assume same as Nature	300 kb	1024 pixels	768 pixels
NATURE	JPG	Adobe RGB 1998 or sRGB	500 kb	1024 pixels	768 pixels

**DATES INTERCLUB
COMPETITION IMAGES ARE DUE TO CLUB DOING JUDGING (CLOSING DATE)**

CPID: Submit digital images (Group B) to Bob Paul, by the date for selection, so that slides and digital images are received by the judging club by Oct.1, Dec. 1, Feb. 1, and Apr. 1.

NATURE: Submit digital images (Group B) to Steve Fisher, by the date for selection, so that the digital images are received by the judging club by Oct. 15, Jan. 15, and Apr 15.

CLUB INFORMATION

SHORT EXPOSURES

“Short Exposures” is the newsletter of the f:67 Camera Club, distributed to club members each odd-numbered month. It is made available on the club’s web page, and hard copies are made for members without internet connections and given to prospective members.

SHORT EXPOSURES EDITOR AND CLUB WEBMASTER

The Editor is Bob Paul. The Editor’s phone is (360) 692-0165, and email is newsletter55@f67cameraclub.org.

The webmaster is Roger Miller, at webmaster55@f67cameraclub.org. The web site address is www.f67cameraclub.org.

MEETINGS LOCATION AND SCHEDULE INFORMATION

Evaluation and program meetings will be held at the Bremerton campus of Olympic College unless members are otherwise notified. The room and building may vary from time to time, as rooms may be assigned based upon college priorities, scheduling of rooms to be done at least a scholastic quarter in advance. Changes in location will be noted in the newsletter and on the web page.

Projected images (slides and digital) are evaluated on the 1st Monday each month. Prints are evaluated on the 3rd Monday each. Program nights are currently held on the 1st Monday in June and August, and the 3rd Monday in March and October. Check the club’s schedule of meetings for details.

**f:67 Camera Club
P.O. Box 105
Allyn, WA 98524**